

# CLIP'N'SHADE

## ASSEMBLY AND OPERATING INSTRUCTIONS



Link to assembly video:  
[youtu.be/2ksf3slmhuk](https://youtu.be/2ksf3slmhuk)



## 1. Safety instructions

### General notes

- Warning notices are marked with the following symbol in the instructions
- Read the instructions before using and operating the product!
- Observe the safety and adjustment instructions!



### Permitted activities

- Only activities described in these instructions are permitted on the product. No other modifications of any kind are permitted. Conversions are made without the written permission of the manufacturer.
- If extensions or modifications are made without written permission, all liability and warranty claims against the customer shall expire.
- the manufacturer.

### Intended use

- The product is an external sun, glare and privacy protection, which is clamped to the window frame without damage / processing.
- Mounting in front of escape windows is prohibited.
- Intended use also includes observing these instructions and complying with the maintenance specifications contained therein.
- The CLIP'N'SHADE may only be used in a standard tilt-turn window.
- The extended roller blind does **not** protect against falling out of the window.

### Safety & Warnings

- Warnings in the instructions must be read and observed!
- The Clip'n'Shade must be mounted and operated according to the mounting instructions!
- The weight can be up to 7kg, it is recommended to assemble the product with **two people!**
- There is a danger of falling during assembly, disassembly, maintenance or cleaning!
- Make sure that no parts fall out of the window during assembly!
- Use the enclosed mounting aid during assembly.

### Operation & Maintenance

- Immediately after installation, check the firm hold of the product in the window.
- In case of upcoming wind or prolonged absence, retract the roller blind.
- Regularly, at least **every 3 months**, check the roller blind for tight fit in the window.

## 2. Check scope of delivery

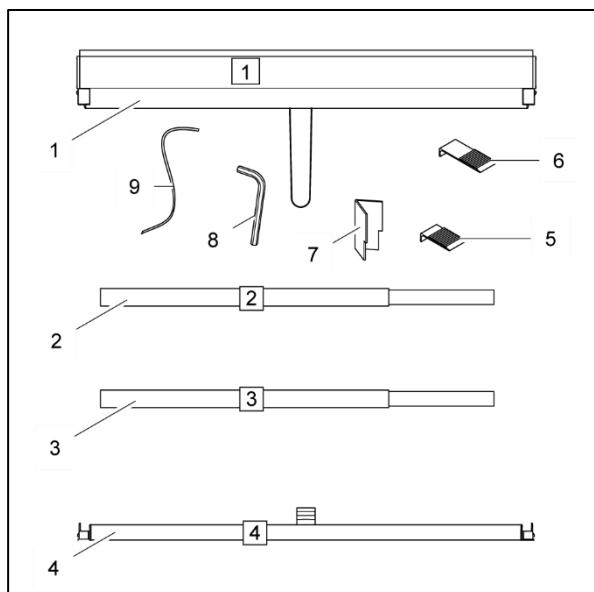

1 = cassette with fabric and handle	2 = Guide rail left
3= Guide rail right	4 = Connection profile
5 = short clip (4x)	6 = long clip (4x)
7 = Setting aid	8 = Allen wrench size 3mm
9 = Mounting aid (cord)	

Check contents for completeness and perfect condition. If parts are missing or damaged, inform the manufacturer immediately and finish the assembly!



## 3. Prepare setting aid

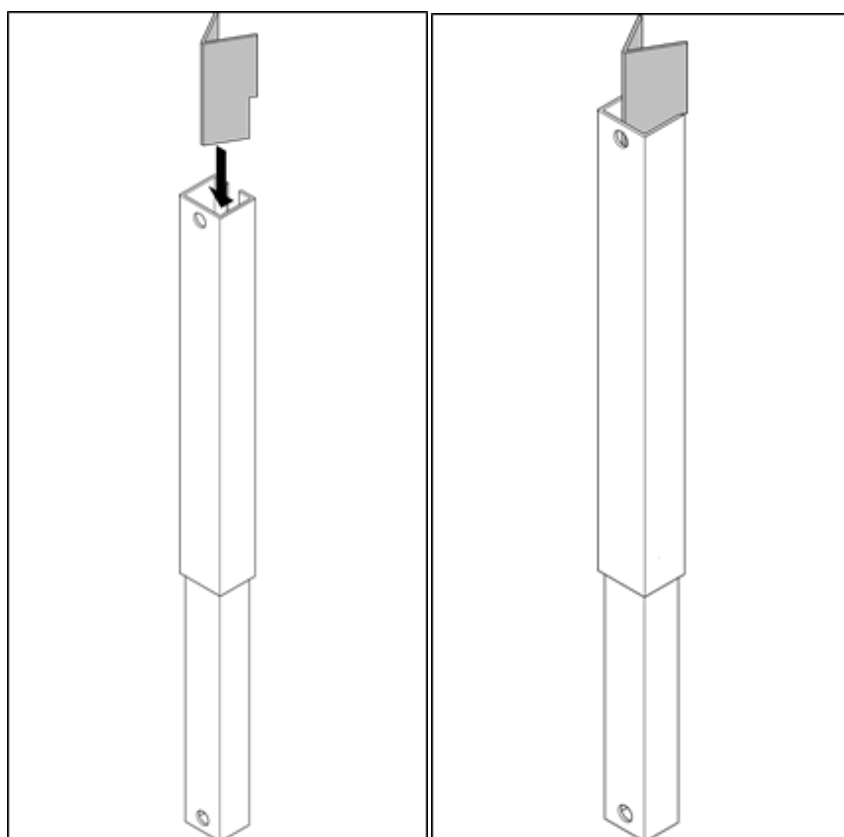

Pull out the smaller guide rail downwards!  
Bend the setting aid in the middle and insert it into the larger guide rail.

#### 4. Adapt guide rail length to window frame

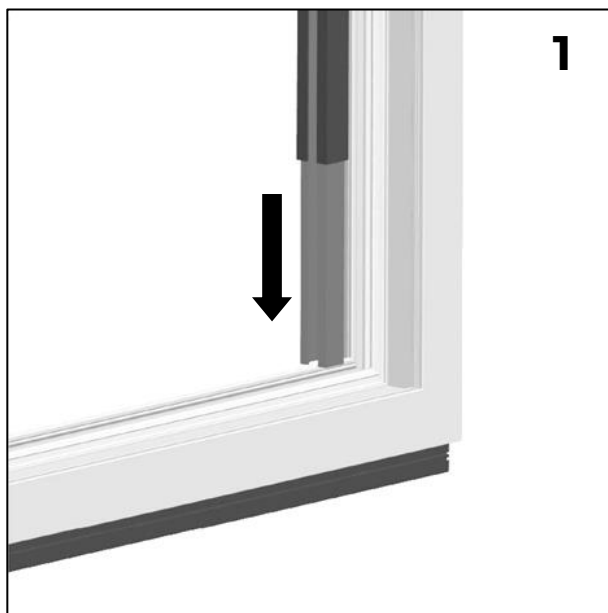

1. Place the guide rail on the bottom of the window frame with the window open!

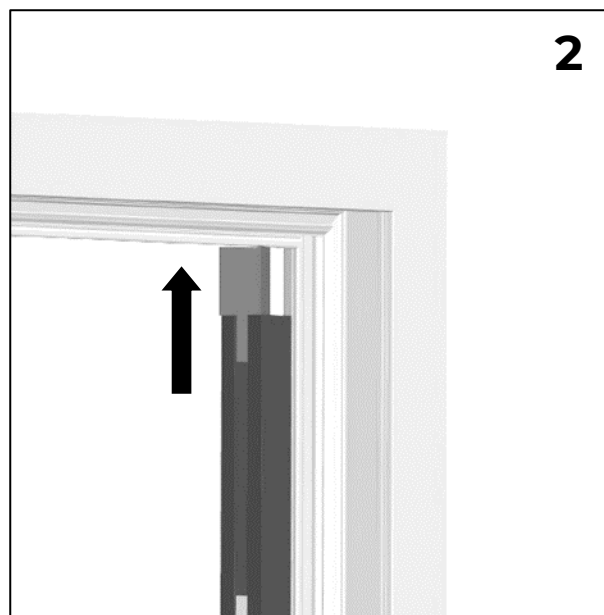

2. Push the guide rail upwards until the adjustment aid touches the top of the window frame!

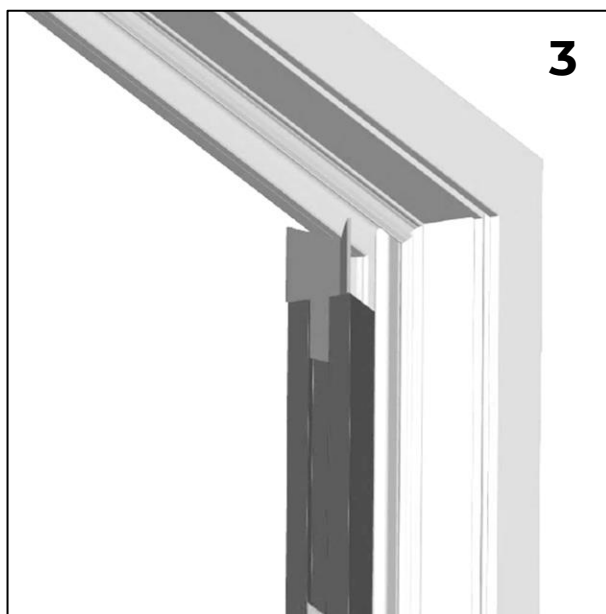

3. **Notice:** The guide rail must be set to the **smallest clear height / smallest distance of** your window frame!

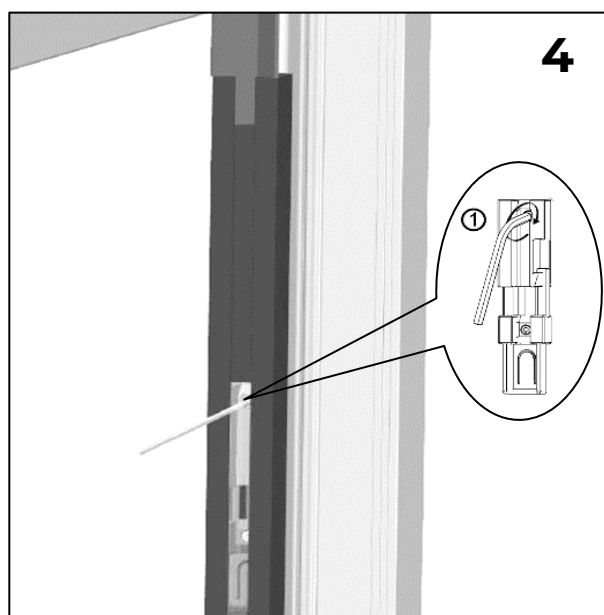

4. Fix the height of the guide rail by tightening the **upper** clamping screw (1) with the Allen key provided.

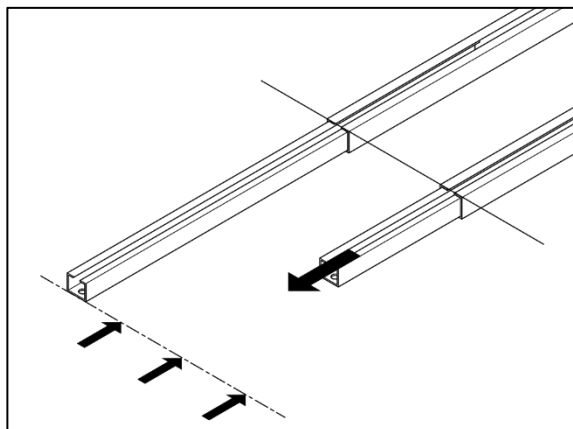

Extend the second guide rail to the same length as the first.

Tighten the **upper** clamping screw (1) of the second guide rail.

**Notice:**

Check screw connection for tight fit. It must no longer be possible to move the guide rails - they must only spring into place.

## 5. Assemble the roller blind

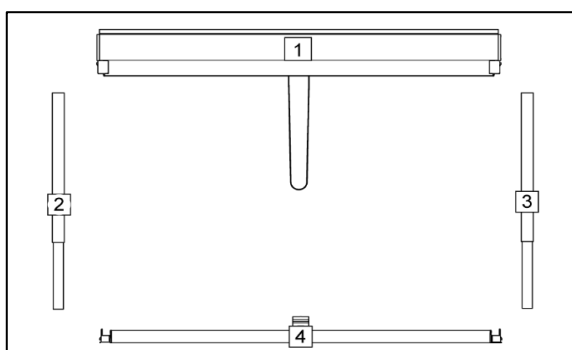

Put the four components on a level surface (table, floor) as shown.!

**Notice:**

The numbering of the components must have the same orientation and be legible.

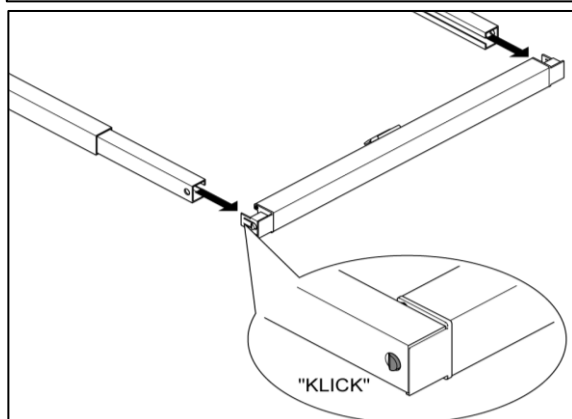

Push both guide rails onto the connecting profile and snap them into place.

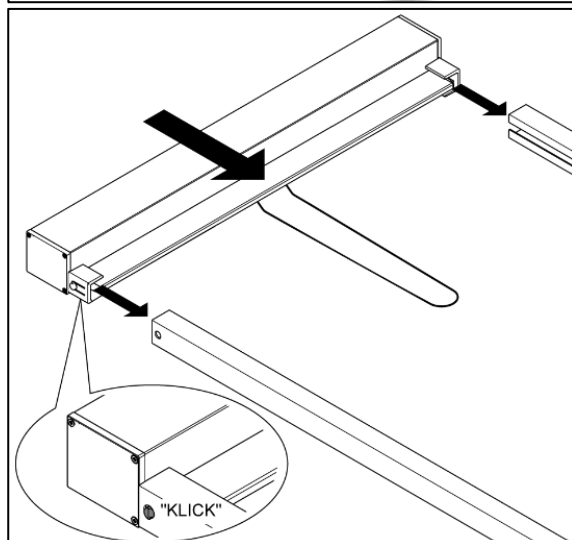

Place the cassette on both guide rails and snap it into place.

**Notice:**

The handle bar must be positioned in the groove of the guide rail.

## 6. Select suitable Clip

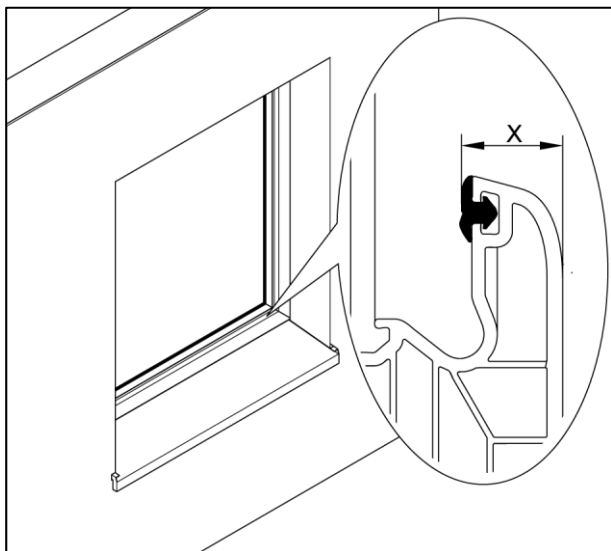

Measure the overlap (X) of the window frame - with the window sash open - and select the appropriate clip (see table)!  
Press the rubber seal together during the measuring process!

### Notice:

The **stick overlap** is the outer projection of the window frame to which the roller blind is attached!

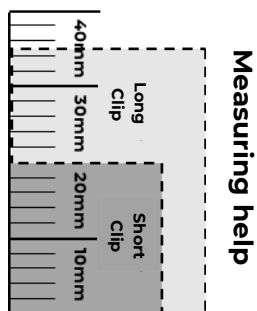

Measuring help

Short Clip X = 0 - 20mm	Long Clip X = 21 - 35mm

## 7. Insert Clip

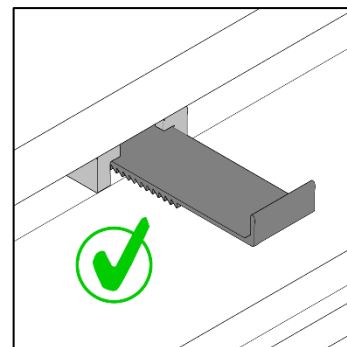
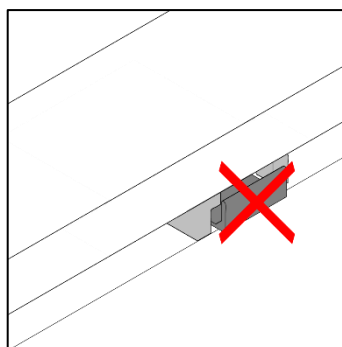
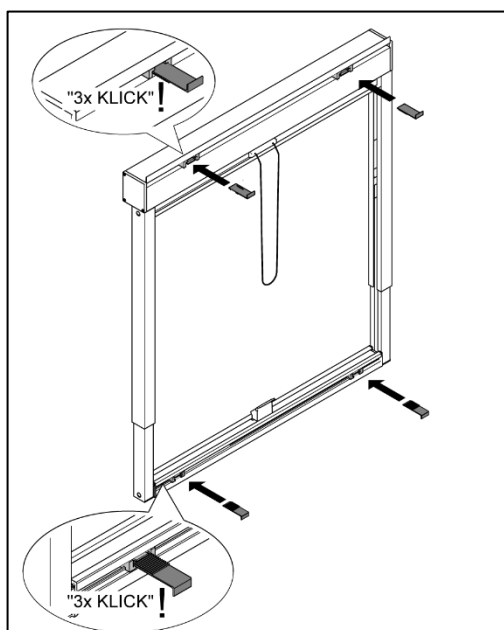

Insert the 4 selected clips into the receptacle provided (2x cassette, 2x connecting profile).



### Notice:

Insert the clips so that the short leg of the clip points towards the foam.  
Insert the clips only **three notches** deep!

## 8. Mounting

Risk of injury from falling roller blind!  
The unsecured roller blind can fall and injure persons!



**Remove the numbering before mounting!**

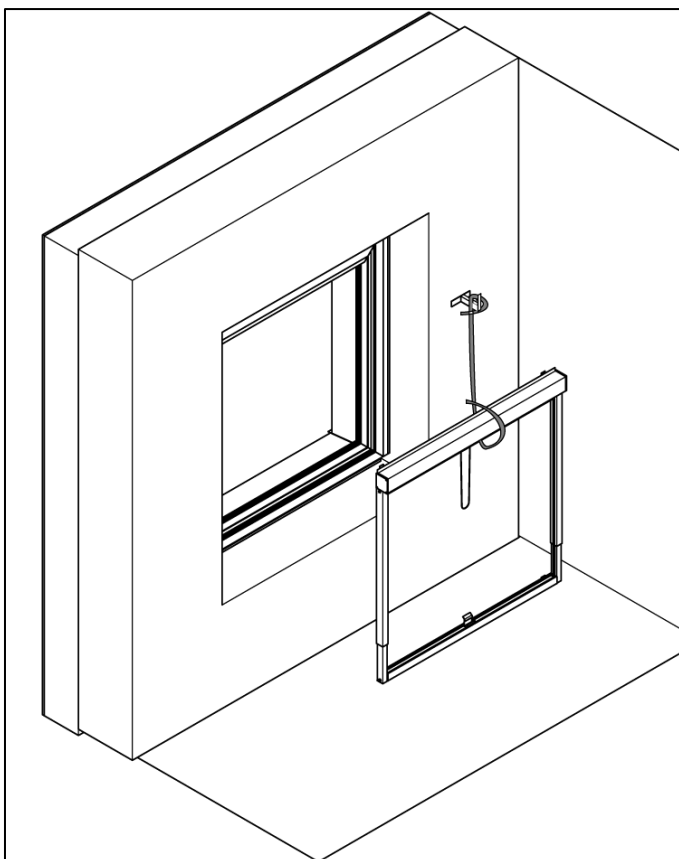

Knot the Cassette with the installation aid (cord) and secure the loose end to an object firmly attached to the masonry! (e.g. heater, window, etc.)

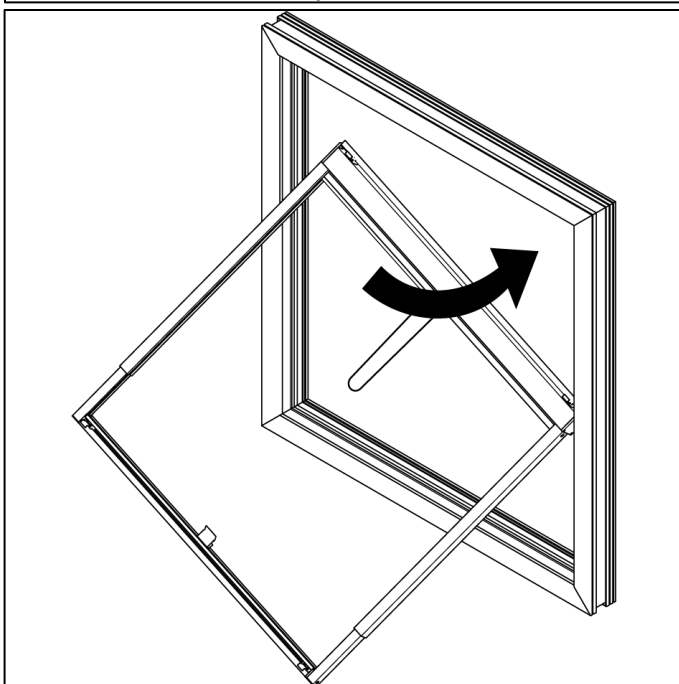

Guide the roller blind to the outside.

### Notice:

For larger products, the assembly should be done with two people!



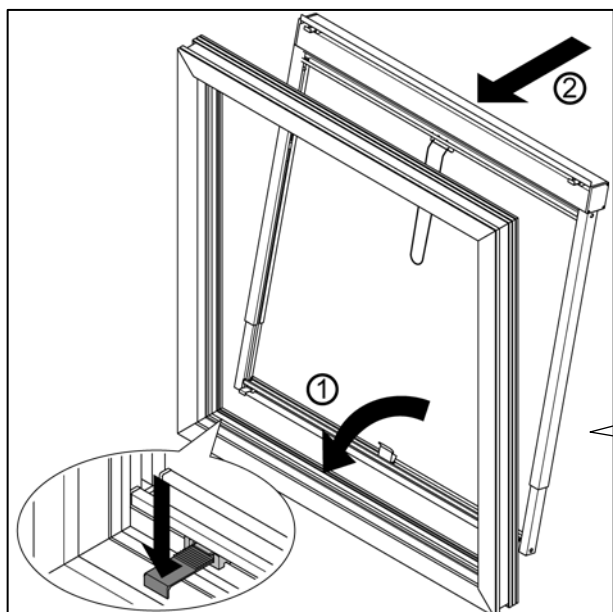

Insert the roller blind with the lower clips over the window frame!

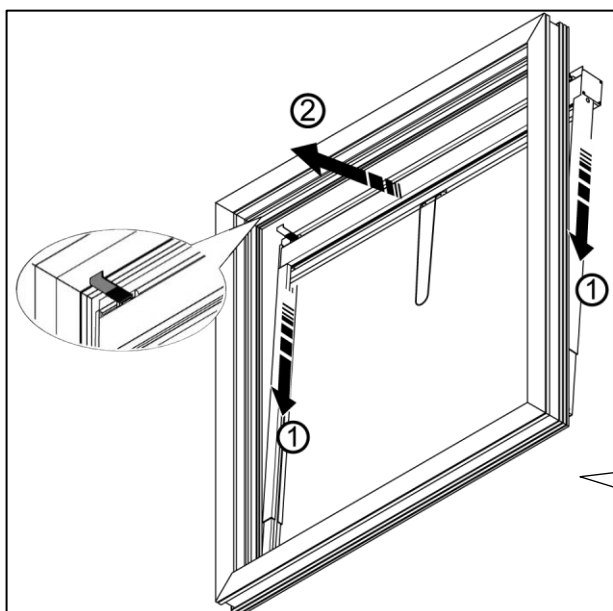
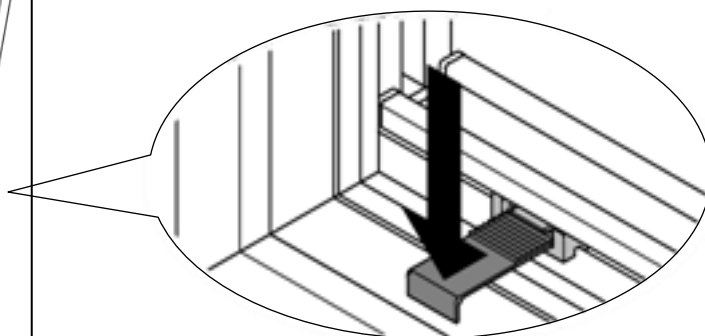

Press the guide rails downwards till it spring in!

Guide upper clips inward and hook them into window frame as well.

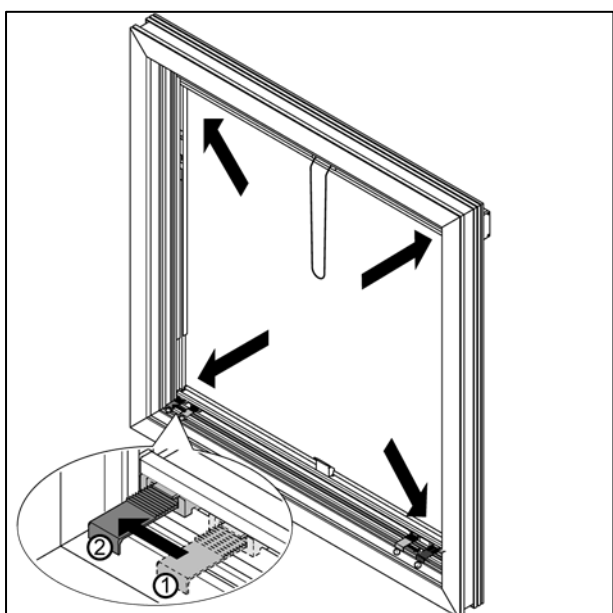
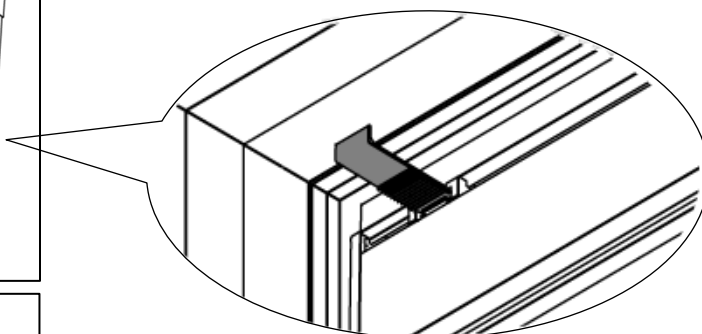

Move all four clips outwards and position the roller blind centrally to the window!

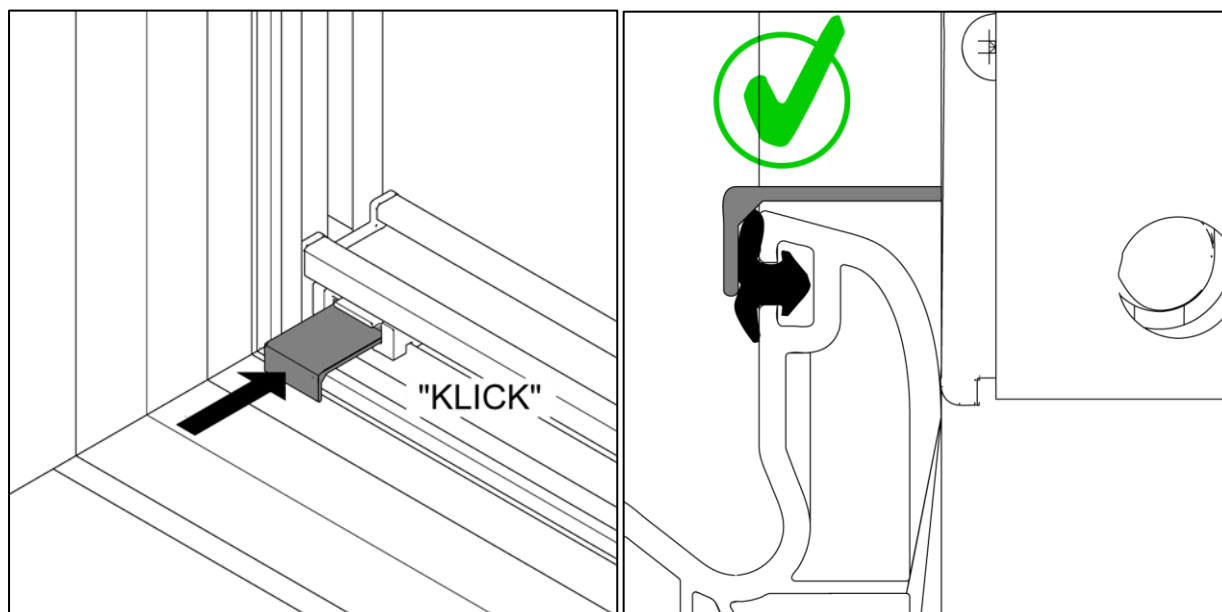

Press in all four clips firmly and secure the roller blind to the window frame as flat as possible!

**Notice:**

Check all four clips for tight and secure fit in the window!

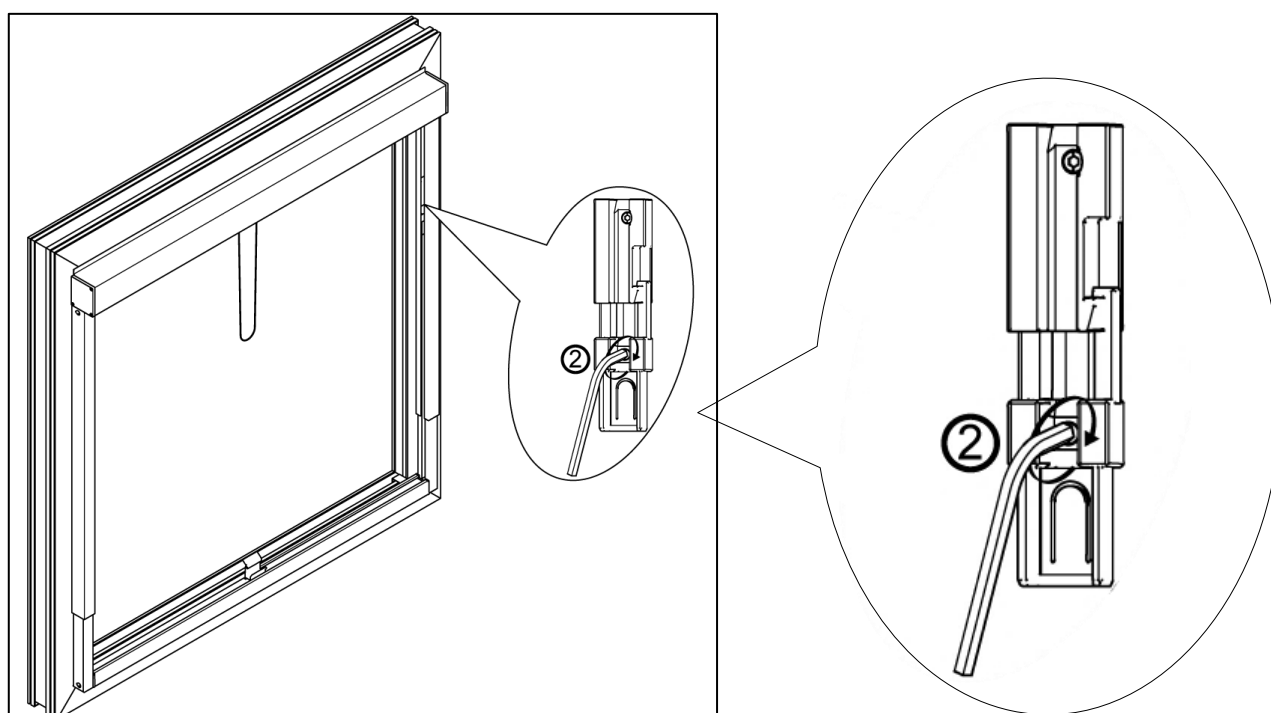

Fix both guide rails by screwing in the **lower** clamping screw (2) with the Allen key!

**Notice:**

Check the tight fit of the product in the window!

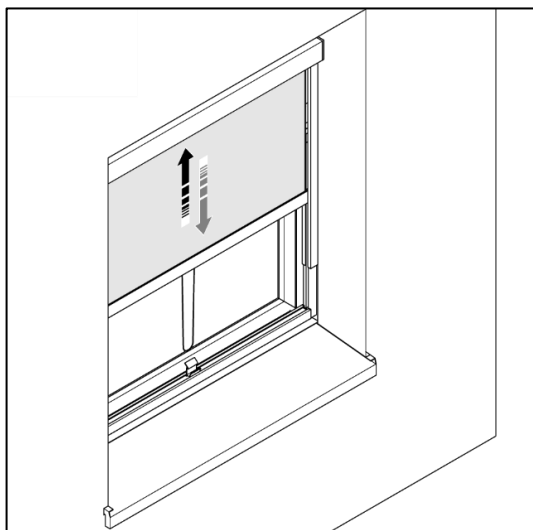

Move the roller blind up and down on the handle bar (optionally on the pull cord) as a test!  
After successful functional testing, the assembly process is complete.

## 9. Operation

### Lock

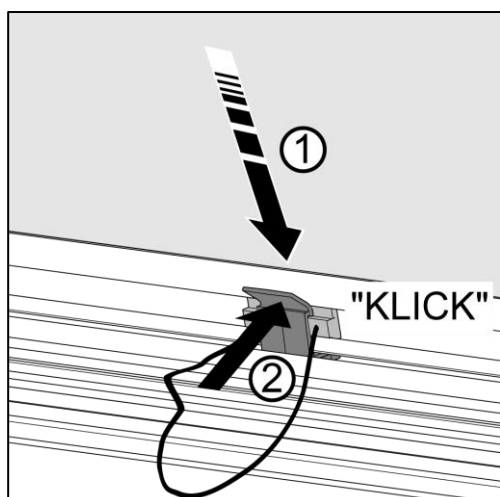

Pull the roller blind down and Engage the handle strip in the operating element!

### Unlock

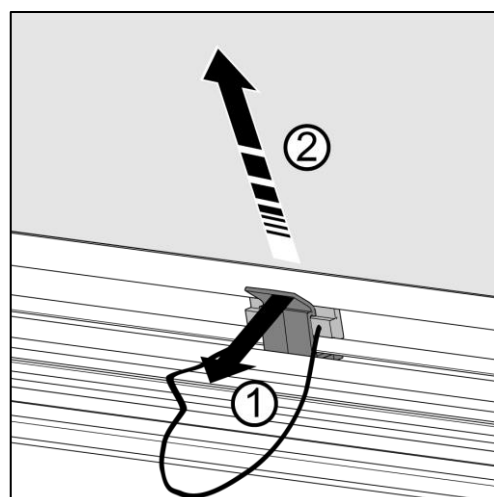

Release the control element and move the roller blind upwards! The roller blind moves upwards independently and braked!

### Intermediate position

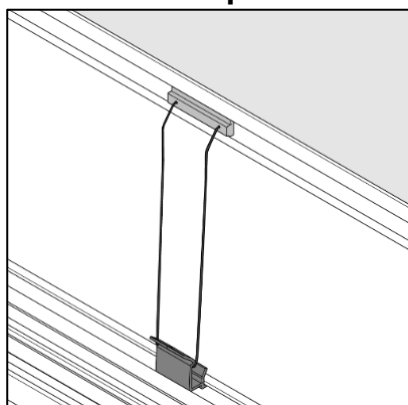

Attach the pull cord to the **outside of the** control element and position the roller blind in the intermediate position!

#### Notice:

If necessary, the intermediate position can be shortened to the desired intermediate height/length by knotting the operating cord.

## 10. Disassembly of the product

The product is disassembled in reverse order!

To remove the clips, use a small flat-blade screwdriver to lift the tab in the clip holder and pull out the clip in the process.

## 11. Operating, care and maintenance instructions

### Operating instructions

- Due to the different outside temperatures, different rewind speeds may occur.
  - Example: At low outdoor temperatures, the roller blind will retract more slowly than at high outdoor temperatures.
- In case of upcoming wind or prolonged absence, retract the roller blind.

### Care instructions

- Do not use sharp or hard objects for cleaning
- Clean the roller blind (fabric and housing) only with water or PH-neutral cleaning agents
- If the fabric should ever get wet, it should dry in the extended state, if possible, so that no moisture collects in the cassette.

### Maintenance instructions

- Check the roller blind regularly, at least **every 3-6 months** annually, to ensure that it is firmly seated in the window.
- If necessary, the screw connections on the guide rails can be retightened.

## 12. Service & Questions

### Mail

info@clipnshade.de



## 13. Imprint

ClipnShade GmbH  
Dillberg 14-16  
97828 Marktheidenfeld  
D - Germany

www.clipnshade.de